



# REFRIGERATION

SERVING THE FOOD INDUSTRY SINCE 1951

## COUNTERTOP CURVED GLASS REFRIGERATED DISPLAY WITH DUAL ACCESS

Item: 31865  
Model: RS-CN-0115-F

Item: 31866  
Model: RS-CN-0155-F



Model RS-CN-0155-F shown

**ATTRACTIVELY DISPLAY FOOD MERCHANDISE AND INCREASE IMPULSE SALE**

Omcan's Countertop Curved Glass Refrigerated Displays with dual access are perfect for supermarkets and sandwich shops. Features an attractive smooth finish, curved glass, and stainless steel body. Comes with digital temperature controller and automatic defrost system. The sliding doors in front and back allow for easy access to product while still maintaining the quality of the refrigerated merchandise.



**WARRANTY**  
PARTS AND LABOR



SHIPPED ON PALLET

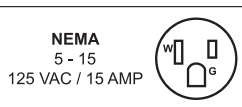

Authorized Dealer

# REFRIGERATION

36-INCH CURVED GLASS REFRIGERATED DISPLAY  
WITH DUAL ACCESS - 4 CU. FT. | RS-CN-0115-F



Item 31866 shown

## FEATURES

- Sliding doors in front and back
- #304 Stainless Steel exterior and interior
- Forced air circulation system
- High quality digital temperature controller
- Middle or high back pressure hermetic compressor
- Automatic defrost system
- R134a Gas, Ozone friendly

## TECHNICAL SPECIFICATIONS

ITEM NUMBER	31865
MODEL	RS-CN-0115-F
TEMPERATURE RANGE	2°C - 8°C / 35.6°F - 46.4°F
CAPACITY (L / CU. FT.)	115 L / 4 cu. ft.
POWER	0.420 kW
CURRENT	4.82A
REFRIGERANT	R134a, 185g
NUMBER OF SHELVES	2
ELECTRICAL	110V / 60Hz / 1Ph
INTERIOR DIMENSIONS (DWH)	15.75" x 35.5" x 14.5" 400.05 x 901.7 x 368.3 mm
DIMENSIONS (DWH)	21.25" x 35.5" x 31" 539.75 x 901.7 x 787.4 mm
PACKAGING DIMENSIONS	39.75" x 25.40" x 40" 1009.65 x 645.16 x 1016 mm
WEIGHT	209.5 lbs. / 95 kg.

## TECHNICAL DRAWINGS AND DIMENSIONS

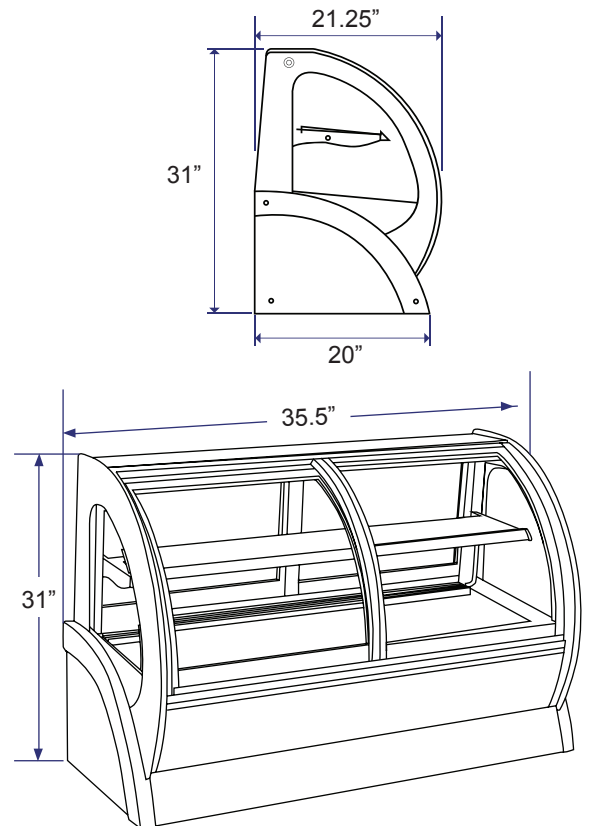

## OMCAN INC.

Telephone: 1-800-465-0234  
Fax: (905) 607-0234  
Email: sales@omcan.com  
Website: www.omcan.com



Follow us to keep up to date with the latest news and offers



# REFRIGERATION

36-INCH CURVED GLASS REFRIGERATED DISPLAY  
WITH DUAL ACCESS - 5.47 CU. FT. | RS-CN-0155-F



Item 31866 shown

## FEATURES

- Sliding doors in front and back
- #304 Stainless Steel exterior and interior
- Forced air circulation system
- High quality digital temperature controller
- Middle or high back pressure hermetic compressor
- Automatic defrost system
- R134a Gas, Ozone friendly

## TECHNICAL SPECIFICATIONS

ITEM NUMBER	31866
MODEL	RS-CN-0155-F
TEMPERATURE RANGE	2°C - 8°C / 35.6°F - 46.4°F
CAPACITY (L / CU. FT.)	155 L / 5.47 cu. ft.
POWER	0.453 kW
CURRENT	4.58A
REFRIGERANT	R134a, 270g
NUMBER OF SHELVES	2
ELECTRICAL	110V / 60Hz / 1Ph
INTERIOR DIMENSIONS (DWH)	15.75" x 47.25" x 14.5" 400.05 x 1200.15 x 368.3 mm
DIMENSIONS (DWH)	21.25" x 47.25" x 31" 539.75 x 1200.15 x 787.4 mm
PACKAGING DIMENSIONS	51.75" x 25.40" x 40" 1314.45 x 645.16 x 1016 mm
WEIGHT	231.5 lbs. / 105 kg.

## TECHNICAL DRAWINGS AND DIMENSIONS

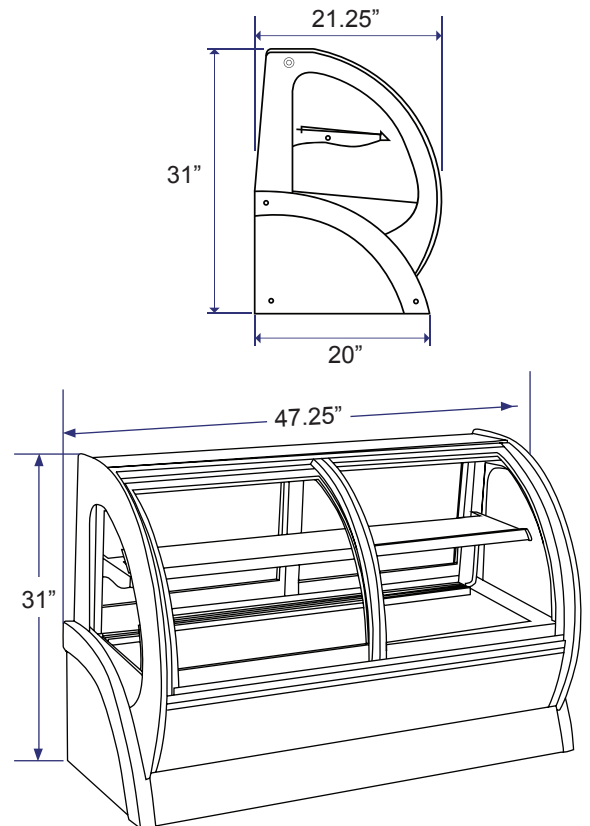

## OMCAN INC.

Telephone: 1-800-465-0234  
Fax: (905) 607-0234  
Email: sales@omcan.com  
Website: www.omcan.com



Follow us to keep up to date with the latest news and offers

